

Customer Care Solutions
NHL-4/4U Series Transceivers

6610/7210 Parts List

[This page left intentionally blank]

Table of Contents

	Page No
Exploded View of Nokia 7210, NHL-4	4
Assembly Parts Lists.....	5
Nokia 6610/7210 common assembly parts	5
Variant Parts (7210)	6
Variant Parts (6610)	6
TB4 module parts, EDMS v.9.3	7
Parts list TK4 UI module 0201827 for NHL-4	18
EDMS v. 3.0	18
Parts list TK7 UI module 0201909 for NHL-4U	19
EDMS v. 2.1	19

Exploded View of Nokia 7210, NHL-4

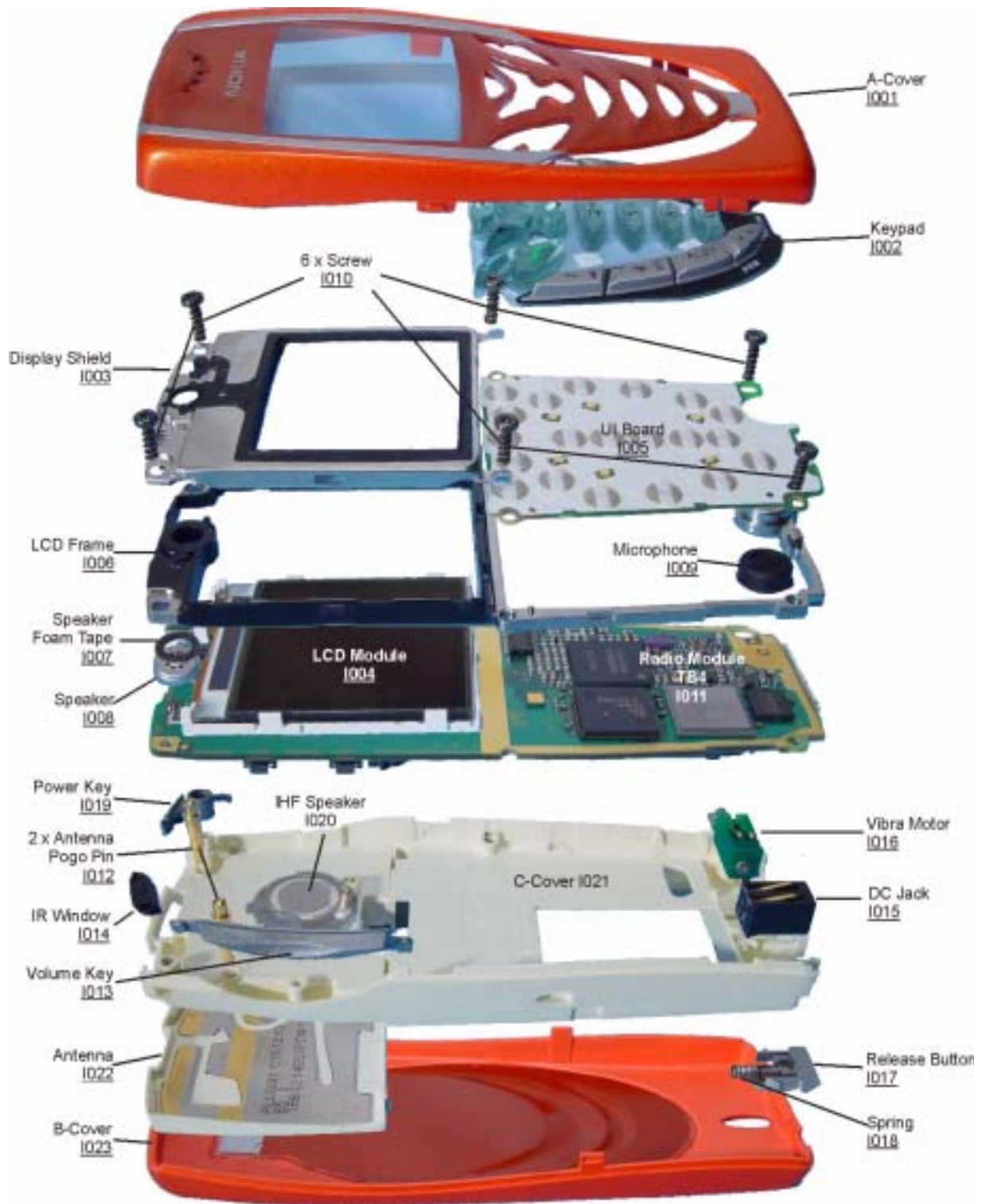

For the parts list refer to the next page.

Assembly Parts Lists

Nokia 6610/7210 common assembly parts

Item/_circuit Ref.	Qty	Part No	Part Name
I003	1	9517173	Display Shield Dmc04171 Nhl-4
I004	1	4850261	Lcd Module 130x130 Cog Colourstn
I005	1	0201827	TK4 UI Board Module (7210)
I005	1	0201909	TK7 UI Board Module (6610)
I006	1	9467076	Lcd Frame Dmc03935 Nhl-4
I007	1	9470283	Speaker Foam Tape
I008	1	5140251	Speaker105+-3db32r D8.1x2.25 Pico
I009	1	5140263	Mic+boot Assy -42+-3db D7.7x3mm
I010	6	6290107	Screw 1.8x7.0 Fe T6+ Dmd05791 Blk
I012	2	5400263	Antenna Pogo Pin L=8.7mm D=2.1mm
I013	1	9452236	Volume Key Dmd07492 Nhl-4
I014	1	9452235	Ir Window Dmd07490 Nhl-4
I015	1	5400243	Conn Dc-jack 3.5mm 3pol Spr 90deg
I016	1	6800057	Vib.motor Assy 1.3 Vdc 11000 Rpm
I017	1	9470205	Release Button Nhl-4
I018	1	9510845	Spring Nhl-4
I019	1	9452237	Power Key Dmd07491 Nhl-4
I020	1	Xxxxxxx	Speaker Hf 69+-2db8r D16x4.36
I022	1	0660264	Antenna Int Antenna Egsm/pcn/pcs (7210)
I022	1	0660267	Antenna Int Antenna Egsm/pcn/pcs (6610)

Variant Parts (7210)

Table 1: 7210 variant parts

ITEM/ _CIRCUIT REF.	QTY	PART NO	PART NAME
I001		9490782	A-cover Assy Dmc03934 Orange
I001		9490783	A-cover Assy Dmc03934 Turquoise
I001		9490784	A-cover Assy Dmc03934 Brown
I002		9790644	Keypad Latin Dmc04451 Nhl-4
I002		9790710	Keypad Arabic Dmc05274 Nhl-4
I002		9790711	Keypad Cyrillic Dmc05275 Nhl-4
I002		9790712	Keypad Greek Dmc05276 Nhl-4
I002		9790713	Keypad Hebrew Dmc05277 Nhl-4
I023		9490773	B-cover Assy Dmc04484 Orange
I023		9490774	B-cover Assy Dmc04484 Turquoise
I023		9490775	B-cover Assy Dmc04484 Brown

Variant Parts (6610)

Table 2: 6610 variant parts

ITEM/ _CIRCUIT REF.	QTY	PART NO	PART NAME
I001		9490826	A-cover Assy Dmc05091 Black
I001		9490827	A-cover Assy Dmc05091 White
I001		9490888	A-cover Assy Dmc05091 Grey
I002		9790719	Keypad Latin Dmc05167 Hdj13
I002		9790726	Keypad Arabic Dmc05296 Hdj13
I002		9790724	Keypad Cyrillic Dmc05294 Hdj13
I002		9790725	Keypad Greek Dmc05295 Hdj13
I002		9790727	Keypad Hebrew Dmc05297 Hdj13
I023		9490833	B-cover Assy Dmc05092 Black
I023		9490832	B-cover Assy Dmc05092 White
I023		9490889	B-cover Assy Dmc08092 Grey

TB4 module parts, EDMS v.9.3

Parts list TB4 engine module 0201789

Table 3: TB4_1

Item	Code	Side	X	Y	Name	Type	Value	
A100	9517151	Bottom	K	5	Shield Assy	dmc04061	~	~
A101	9517151	Bottom	E	6	Shield Assy	dmc04061	~	~
A102	9517174	Bottom	P	7	Shield Assy	dmc01304	~	~
B200	4510219	Top	Q	7	Crystal	cx_4v	32.768kHz	
C100	2315201	Bottom	G	5	Chip Array	0405_2_P0.65	2x27p	25V
C101	2320481	Top	S	5	Chipcap X5r	0603C	1u0	6.3V
C102	2320481	Top	T	5	Chipcap X5r	0603C	1u0	6.3V
C103	2321013	Top	Q	7	Chipcap Np0	0402C	270p	25V
C104	2315201	Top	T	6	Chip Array	0405_2_P0.65	2x27p	25V
C106	2320744	Top	R	6	Chipcap	0402C	1n0	50V
C107	2320536	Top	S	7	Chipcap	0402C	10p	50V
C108	2320536	Top	S	7	Chipcap N	0402C	10p	50V
C109	2320536	Top	S	7	Chipcap	0402C	10p	50V
C110	2320544	Top	S	6	Chipcap	0402C	22p	50V
C112	2320778	Top	T	5	Chipcap	0402C	10n	16V
C113	2320756	Top	S	7	Chipcap N	0402C	3n3	50V
C114	2320756	Top	T	6	Chipcap	0402C	3n3	50V
C115	2320756	Top	R	8	Chipcap	0402C	3n3	50V
C116	2320756	Top	S	8	Chipcap	0402C	3n3	50V
C117	2320536	Top	T	7	Chipcap N	0402C	10p	50V
C118	2320756	Top	S	7	Chipcap	0402C	3n3	50V
C119	2320756	Top	T	7	Chipcap	0402C	3n3	50V
C150	2320805	Top	R	7	Chipcap	0402C	100n	10V
C151	2315205	Top	S	6	Chip Array	0405_2_P0.65	2x1n	16V
C152	2320805	Top	T	6	Chipcap	0402C	100n	10V
C153	2315209	Top	S	6	Chipcap	0405_2_P0.65	2x33n	10V
C154	2315209	Top	Q	6	Chipcap N	0405_2_P0.65	2x33n	10V
C155	2315201	Top	Q	7	Chipcap	0405_2_P0.65	2x27p	25V
C156	2315205	Top	Q	7	Chip Array	0405_2_P0.65	2x1n	16V

Table 3: TB4_1

Item	Code	Side	X	Y	Name	Type	Value	
C157	2315201	Top	S	6	Chip Array	0405_2_P0.65	2x27p	25V
C158	2315201	Top	S	7	Chip Array	0405_2_P0.65	2x27p	25V
C159	2315201	Top	R	7	Chip Array	0405_2_P0.65	2x27p	25V
C160	2320805	Top	R	6	Chipcap	0402C	100n	10V
C161	2320805	Top	R	7	Chipcap	0402C	100n	10V
C162	2320805	Top	R	8	Chipcap N	0402C	100n	10V
C163	2320805	Top	R	7	Chipcap	0402C	100n	10V
C164	2315205	Bottom	H	7	Chip Array	0405_2_P0.65	2x1n	16V
C165	2320805	Top	R	8	Chipcap	0402C	100n	10V
C166	2320481	Top	R	7	Chipcap	0603C	1u0	6.3V
C167	2320481	Top	R	6	Chipcap	0603C	1u0	6.3V
C168	2320805	Bottom	P	7	Chipcap	0402C	100n	10V
C169	2320805	Top	R	6	Chipcap	0402C	100n	10V
C200	2320805	Top	O	8	Chipcap	0402C	100n	10V
C201	2320481	Top	N	8	Chipcap	0603C	1u0	6.3V
C202	2320778	Top	N	8	Chipcap	0402C	10n	16V
C203	2320481	Top	Q	5	Chipcap	0603C	1u0	6.3V
C204	2320481	Top	O	8	Chipcap	0603C	1u0	6.3V
C205	2320481	Top	P	8	Chipcap	0603C	1u0	6.3V
C206	2320481	Top	O	8	Chipcap	0603C	1u0	6.3V
C207	2320481	Top	Q	5	Chipcap	0603C	1u0	6.3V
C208	2320481	Top	O	8	Chipcap	0603C	1u0	6.3V
C209	2320536	Top	Q	8	Chipcap	0402C	10p	50V
C210	2320536	Top	Q	8	Chipcap	0402C	10p	50V
C211	2320481	Top	P	8	Chipcap	0603C	1u0	6.3V
C212	2320481	Top	P	8	Chipcap	0603C	1u0	6.3V
C213	2320481	Top	P	8	Chipcap	0603C	1u0	6.3V
C214	2320481	Top	Q	7	Chipcap	0603C	1u0	6.3V
C215	2320481	Top	Q	6	Chipcap	0603C	1u0	6.3V
C218	2320805	Top	Q	6	Chipcap	0402C	100n	10V
C219	2320481	Top	N	8	Chipcap	0603C	1u0	6.3V
C220	2320778	Top	Q	5	Chipcap	0402C	10n	16V

Table 3: TB4_1

Item	Code	Side	X	Y	Name	Type	Value	
C221	2320481	Top	N	8	Chipcap	0603C	1u0	6.3V
C222	2320481	Top	N	6	Chipcap	0603C	1u0	6.3V
C223	2320481	Top	M	6	Chipcap	0603C	1u0	6.3V
C224	2320481	Top	M	6	Chipcap	0603C	1u0	6.3V
C225	2320481	Top	N	6	Chipcap	0603C	1u0	6.3V
C226	2320481	Top	N	6	Chipcap	0603C	1u0	6.3V
C227	2320481	Top	M	6	Chipcap	0603C	1u0	6.3V
C228	2320481	Top	N	5	Chipcap	0603C	1u0	6.3V
C229	2320481	Top	M	5	Chipcap	0603C	1u0	6.3V
C230	2320481	Top	M	6	Chipcap	0603C	1u0	6.3V
C231	2320481	Top	N	6	Chipcap	0603C	1u0	6.3V
C232	2320481	Top	N	6	Chipcap	0603C	1u0	6.3V
C233	2320481	Top	N	6	Chipcap	0603C	1u0	6.3V
C234	2320481	Top	N	5	Chipcap	0603C	1u0	6.3V
C235	2320481	Top	Q	8	Chipcap	0603C	1u0	6.3V
C236	2320805	Top	N	5	Chipcap	0402C	100n	10V
C237	2320805	Top	N	5	Chipcap	0402C	100n	10V
C238	2320805	Top	O	7	Chipcap	0402C	100n	10V
C239	2320805	Top	R	6	Chipcap	0402C	100n	10V
C240	2320778	Top	Q	6	Chipcap	0402C	10n	16V
C241	2320744	Top	Q	6	Chipcap	0402C	1n0	50V
C242	2320744	Top	Q	6	Chipcap	0402C	1n0	50V
C243	2320481	Top	R	6	Chipcap	0603C	1u0	6.3V
C260	2320481	Top	N	7	Chipcap	0603C	1u0	6.3V
C261	2320481	Top	P	8	Chipcap	0603C	1u0	6.3V
C262	2320481	Top	N	7	Chipcap	0603C	1u0	6.3V
C263	2320481	Top	N	7	Chipcap	0603C	1u0	6.3V
C264	2320481	Top	O	8	Chipcap	0603C	1u0	6.3V
C265	2320481	Top	R	5	Chipcap	0603C	1u0	6.3V
C302	2320556	Bottom	H	7	Chipcap	0402C	68p	50V
C303	2320125	Bottom	I	8	Chipcap	0603C	1u0	16V
C304	2320125	Bottom	I	9	Chipcap	0603C	1u0	16V

Table 3: TB4_1

Item	Code	Side	X	Y	Name	Type	Value	
C306	2320778	Bottom	S	6	Chipcap	0402C	10n	16V
C310	2320544	Bottom	B	6	Chipcap	0402C	22p	50V
C350	2312243	Bottom	B	5	Chipcap	0805C	4u7	6V3
C352	2320805	Bottom	B	4	Chipcap	0402C	100n	10V
C353	2320805	Bottom	C	4	Chipcap	0402C	100n	10V
C357	2320778	Bottom	P	8	Chipcap	0402C	10n	16V
C358	2320785	Bottom	P	8	Chipcap	0402C	47n	10V
C359	2320805	Bottom	P	7	Chipcap	0402C	100n	10V
C361	2320744	Bottom	N	6	Chipcap	0402C	1n0	50V
C362	2320778	Bottom	P	7	Chipcap	0402C	10n	16V
C363	2315261	Bottom	N	8	Chip Array	0405_2_P0.65	2x47n	10V
C364	2321007	Bottom	N	6	Cercap	0402C	22n	16V
C365	2315209	Bottom	N	7	Chip Array	0405_2_P0.65	2x33n	10V
C366	2320785	Bottom	N	7	Chipcap	0402C	47n	10V
C367	2320560	Bottom	P	8	Chipcap	0402C	100p	50V
C370	2320760	Bottom	O	8	Chipcap	0402C	4n7	25V
C371	2320778	Bottom	O	8	Chipcap	0402C	10n	16V
C372	2320481	Bottom	O	8	Chipcap	0603C	1u0	6.3V
C373	2321007	Bottom	N	6	Ceramic cap.	0402C	22n	16V
C374	2320744	Bottom	O	6	Chipcap	0402C	1n0	50V
C375	2320752	Bottom	O	6	Chipcap	0402C	2n2	50V
C378	2320546	Bottom	O	8	Chipcap	0402C	27p	50V
C379	2320552	Bottom	O	8	Chipcap	0402C	47p	50V
C390	2320805	Bottom	T	3	Chipcap	0402C	100n	10V
C400	2320778	Top	Q	4	Chipcap	0402C	10n	16V
C401	2320805	Top	Q	4	Chipcap	0402C	100n	10V
C402	2320778	Top	N	4	Chipcap	0402C	10n	16V
C403	2320778	Top	N	3	Chipcap	0402C	10n	16V
C404	2320778	Top	Q	3	Chipcap	0402C	10n	16V
C405	2320778	Top	N	4	Chipcap	0402C	10n	16V
C420	2320560	Top	N	4	Chipcap	0402C	100p	50V
C421	2320560	Top	N	5	Chipcap	0402C	100p	50V

Table 3: TB4_1

Item	Code	Side	X	Y	Name	Type	Value	
C422	2320560	Top	N	5	Chipcap	0402C	100p	50V
C450	2320778	Top	T	3	Chipcap	0402C	10n	16V
C451	2320805	Top	Q	4	Chipcap	0402C	100n	10V
C452	2320805	Top	U	4	Chipcap	0402C	100n	10V
C454	2320779	Top	R	5	Chipcap	0603_BLM	100n	16V
C500	2320598	Bottom	K	7	Chipcap	0402C	3n9	50V
C501	2320744	Bottom	M	3	Chipcap	0402C	1n0	50V
C503	2320564	Bottom	M	4	Chipcap	0402C	150p	50V
C504	2322023	Bottom	L	4	Chipcap	0603C	2n2	16V
C505	2321013	Bottom	L	6	Chipcap	0402C	270p	25V
C507	2322023	Bottom	J	6	Chipcap	0603C	2n2	16V
C511	2320560	Bottom	G	3	Chipcap	0402C	100p	50V
C520	2320554	Bottom	K	7	Chipcap	0402C	56p	50V
C522	2320604	Bottom	K	7	Chipcap	0402C	18p	50V
C531	2320546	Bottom	C	6	Chipcap	0402C	27p	50V
C532	2320604	Bottom	J	5	Chipcap	0402C	18p	50V
C533	2320554	Bottom	J	5	Chipcap	0402C	56p	50V
C535	2320552	Bottom	M	6	Chipcap	0402C	47p	50V
C536	2320552	Bottom	M	6	Chipcap	0402C	47p	50V
C537	2320560	Bottom	L	7	Chipcap	0402C	100p	50V
C540	2320491	Bottom	M	8	Chipcap	0603C	220n	10V
C543	2320558	Bottom	L	5	Chipcap	0402C	82p	50V
C545	2315019	Bottom	K	4	Chip Array	0612_H0.94	4x470p	~
C549	2320805	Bottom	L	4	Chipcap	0402C	100n	10V
C550	2320570	Bottom	L	7	Chipcap	0402C	270p	50V
C551	2320546	Bottom	L	6	Chipcap	0402C	27p	50V
C552	2320805	Bottom	L	6	Chipcap	0402C	100n	10V
C553	2320536	Bottom	M	6	Chipcap	0402C	10p	50V
C554	2320620	Bottom	K	4	Chipcap	0402C	10n	16V
C555	2320805	Bottom	L	5	Chipcap	0402C	100n	10V
C560	2320536	Bottom	M	3	Chipcap	0402C	10p	50V
C568	2320907	Bottom	K	6	Chipcap	0402C_AVX	0p7	16V

Table 3: TB4_1

Item	Code	Side	X	Y	Name	Type	Value	
C570	2320544	Bottom	K	6	Chipcap	0402C	22p	50V
C703	2310045	Bottom	D	8	Chipcap	0402C_GRM36	68n	10V
C704	2310045	Bottom	E	8	Chipcap	0402C_GRM36	68n	10V
C705	2320546	Bottom	E	8	Chipcap	0402C	27p	50V
C706	2320546	Bottom	E	8	Chipcap	0402C	27p	50V
C707	2320518	Bottom	C	8	Chipcap	0402C	1p8	50V
C709	2320540	Bottom	G	8	Chipcap	0402C	15p	50V
C710	2320540	Bottom	F	8	Chipcap	0402C	15p	50V
C711	2320522	Bottom	F	7	Chipcap	0402C	2p7	50V
C713	2320584	Bottom	D	8	Chipcap	0402C	1n0	50V
C714	2320584	Bottom	F	8	Chipcap	0402C	1n0	50V
C715	2320554	Bottom	F	6	Chipcap	0402C	56p	50V
C718	2320584	Bottom	C	6	Chipcap	0402C	1n0	50V
C723	2320540	Bottom	F	6	Chipcap	0402C	15p	50V
C725	2312243	Bottom	F	5	Chipcap	0805C	4u7	6V3
C726	2320546	Bottom	G	5	Chipcap	0402C	27p	50V
C727	2611745	Bottom	I	7	Chipcap	TANT_TPSY	150u	10V
C728	2320560	Bottom	E	8	Chipcap	0402C	100p	50V
C729	2320554	Bottom	D	5	Chipcap	0402C	56p	50V
C731	2320560	Bottom	G	5	Chipcap	0402C	100p	50V
C732	2320744	Bottom	G	5	Chipcap	0402C	1n0	50V
C804	2320560	Bottom	D	5	Chipcap	0402C	100p	50V
C805	2320560	Bottom	E	3	Chipcap	0402C	100p	50V
C806	2320536	Bottom	D	5	Chipcap	0402C	10p	50V
C807	2320560	Bottom	J	5	Chipcap	0402C	100p	50V
C808	2320560	Bottom	J	5	Chipcap	0402C	100p	50V
C826	2320522	Bottom	F	3	Chipcap	0402C	2p7	50V
C827	2320805	Bottom	F	4	Chipcap	0402C	100n	10V
C828	2320540	Bottom	F	4	Chipcap	0402C	15p	50V
C829	2320516	Bottom	F	4	Chipcap	0402C	1p5	50V
C831	2320552	Bottom	C	5	Chipcap	0402C	47p	50V
C836	2320530	Bottom	D	3	Chipcap	0402C	5p6	50V

Table 3: TB4_1

Item	Code	Side	X	Y	Name	Type	Value	
C837	2320530	Bottom	D	3	Chipcap	0402C	5p6	50V
C838	2320526	Bottom	D	3	Chipcap	0402C	3p9	50V
C839	2320526	Bottom	D	3	Chipcap	0402C	3p9	50V
D200	4370841	Top	O	6	UEM V6.0 W-dog Ena To09l	uBGA168	~	~
D400	4370873	Top	O	3	UPP 8m V2.2 F751986b	uBGA144_CC	~	~
D450	4341331	Top	R	4	Nor Flash 54mhz	uBGA40_128M	8Mx16	~
D452	4341423	Top	T		SRAM 512kx8 1.8v	uBGA48	512kx8	~
F100	5119019	Bottom	T	4	Sm Fuse F	0603_FUSE	1.5A	~
G300	4700131	Bottom	H	3	Cell Capacitor 0.01mah	XH414_IIO2N	3V3	~
G500	4350353	Bottom	L	3	Vco	FDK_IM_H1.8	3420-3980MHz	
G501	4510349	Bottom	L	7	Vctcxo	VCTCXO_KT20	26MHz	~
L100	3203743	Top	S	5	Ferr.bead 0r03	0805_BLM21	42R/100MHz	
L101	3203725	Top	T	6	Ferrite Bead	FERRITE_0402	600R/100MHz	
L102	3203803	Top	S	8	Chip Bead Array	0405_2_H1.0	2x1000R/100MHz	
L103	3203803	Top	T	6	Chip Bead Array	0405_2_H1.0	2x1000R/100MHz	
L104	3203803	Top	S	7	Chip Bead Array	0405_2_H1.0	2x1000R/100MHz	
L105	3645011	Top	T	8	Chip Coil	COIL_LK_1608	68nH	~
L106	3203725	Top	U	5	Ferrite Bead	FERRITE_0402	600R/100MHz	
L107	3203741	Top	U	5	Ferrite Bead	0603_BLM	600R/100MHz	
L150	3203803	Top	B	4	Chip Bead Array	0405_2_H1.0	2x1000R/100MHz	
L151	3645349	Bottom	H	6	Chip Coil	COIL_0603CS	33nH	~
L152	3645349	Bottom	H	6	Chip Coil	COIL_0603CS	33nH	~
L260	3203741	Top	M	7	Ferrite Bead	0603_BLM	600R/100MHz	
L261	3203741	Top	O	8	Ferrite Bead	0603_BLM	600R/100MHz	
L262	3203741	Top	N	7	Ferrite Bead	0603_BLM	600R/100MHzx	
L263	3203741	Top	N	7	Ferrite Bead	0603_BLM	600R/100MHz	
L264	3203741	Top	N	8	Ferrite Bead	0603_BLM	600R/100MHz	
L265	3203741	Top	R	6	Ferrite Bead	0603_BLM	600R/100MHz	
L300	3640119	Bottom	H	8	Choke	CHOKE_984FB	22uH	~
L356	3645349	Bottom	P	7	Chip Coil	COIL_0603CS	33nH	~
L357	3645349	Bottom	P	7	Chip Coil	COIL_0603CS	33nH	~
L358	3645233	Bottom	O	8	Chip Coil	JELF243Q	120nH	~

Table 3: TB4_1

Item	Code	Side	X	Y	Name	Type	Value	
L500	3646053	Bottom	K	7	Chip Coil	0402L	4n7H	~
L501	3646053	Bottom	K	7	Chip Coil	0402L	4n7H	~
L511	3203725	Bottom	L	8	Ferrite Bead	FERRITE_0402	600R/100MHz	
L700	3646069	Bottom	D	8	Chip Coil	0402L	33nH	~
L701	3646063	Bottom	C	8	Chip Coil	0402L	22nH	~
L702	3646053	Bottom	F	7	Chip Coil	0402L	4n7H	~
L703	3203743	Bottom	F	5	Ferr.bead	0805_BLM21	42R/100MHz	
L800	3646051	Bottom	F	4	Chip Coil	0402L	3n9H	~
L805	3646009	Bottom	J	5	Chip Coil	0402L	10nH	~
L809	3646009	Bottom	J	4	Chip Coil	0402L	10nH	~
L810	3646009	Bottom	J	4	Chip Coil	0402L	10nH	~
L821	3646065	Bottom	D	3	Chip Coil	0402L	12nH	~
L824	3646047	Bottom	F	3	Chip Coil	0402L	3n3H	~
L827	3646055	Bottom	J	5	Chip Coil	0402L	8n2H	~
N100	4341063	Top	T	5	Reg 2.8v/150ma Lp3985	SOT23_5_H1.2	~	2.8V
N150	4341345	Top	S	6	Af Amp /(Lm4855bla18aab)	USMD_18	~	~
N300	4341309	Bottom	H	8	Dc/dc Conv 350ma	SOT23L_8	~	~
N350	4860181	Bottom	B	3	IRDA	TFBS5607	~	~
N356	*	Bottom	O	7	FM receiver	TEA 5767H	~	~
N500	4370895	Bottom	K	65	Hlga618a	uBGA_108_P	~	~
N700	4350383	Bottom	E		PWAMP	RF9219_E1	~	~
R100	1430726	Top	T	6	Resistor 5% 63mw	0402R	100R	~
R101	1430726	Top	T	6	Resistor 5% 63mw	0402R	100R	~
R102	1430726	Top	T	6	Resistor 5% 63mw	0402R	100R	~
R103	4120011	Top	U	6	Zdix4 Ip4043cx5	uBGA5	~	~
R104	1430812	Top	T	6	Resistor 5% 63mw	0402R	220k	~
R105	1825033	Top	S	7	Chip Varistor	0402_VAR	14V/46V	
R106	1825033	Top	S	7	Chip Varistor Vw14v Vc46v	0402_VAR	14V/46V	
R107	1825033	Top	S	7	Chip Varistor Vw14v Vc46v	0402_VAR	14V/46V	
R108	1825033	Top	S	7	Chip Varistor Vw14v Vc46v	0402_VAR	14V/46V	
R109	1430804	Top	Q	6	Resistor 5% 63mw	0402R	100k	~
R111	1430804	Top	S	5	Resistor 5% 63mw	0402R	100k	~

Table 3: TB4_1

Item	Code	Side	X	Y	Name	Type	Value
R151	1825033	Top	B	4	Chip Varistor Vw	0402_VAR	14V/46V
R152	1825033	Top	B	4	Chip Varistor Vw	0402_VAR	14V/46V
R153	1430137	Top	R	7	Chipres 0w06 1k0 F 200ppm	0402R	1k0 ~
R154	1430137	Top	R	7	Chipres 0w06 1k0 F 200ppm	0402R	1k0 ~
R155	1620105	Top	R	7	Res Network 0w06 2x2k2 J	MNR02	2x2k2 ~
R156	1430762	Top	S	6	Resistor 5% 63mw	0402R	2k2 ~
R157	1620105	Top	S	6	Res Network 0w06 2x2k2 J	MNR02	2x2k2 ~
R158	1825033	Top	S	8	Chip Varistor Vw14v Vc46v	0402_VAR	14V/46V
R159	1825033	Top	R	8	Chip Varistor Vw14v Vc46v	0402_VAR	14V/46V
R161	1825033	Bottom	G	7	Chip Varistor Vw14v Vc46v	0402_VAR	14V/46V
R162	1825033	Bottom	H	7	Chip Varistor Vw14v Vc46v	0402_VAR	14V/46V
R163	1430764	Top	R	6	Resistor 5% 63mw	0402R	3k3 ~
R164	1430700	Top	S	6	Resistor 5% 63mw	0402R	10R ~
R165	1430700	Top	S	6	Resistor 5% 63mw	0402R	10R ~
R166	1430700	Top	S	7	Resistor 5% 63mw	0402R	10R ~
R167	1430700	Top	S	7	Resistor 5% 63mw	0402R	10R ~
R200	1414605	Top	O	8	Chipres 0w25 J Therm	0805R_THERM	0R22 ~
R202	1620043	Top	Q	6	Res Network 0w03 J	EXB28V	4x100k ~
R206	1430770	Top	Q	6	Resistor 5% 63mw	0402R	4k7 ~
R207	1430770	Top	Q	6	Resistor 5% 63mw	0402R	4k7 ~
R300	1430712	Bottom	H	7	Resistor 5% 63mw	0402R	27R ~
R301	1430734	Top	N	8	Resistor 5% 63mw	0402R	220R ~
R306	1430778	Bottom	B	6	Resistor 5% 63mw	0402R	10k ~
R307	1825033	Top	L	6	Chip Varistor Vw14v Vc46v	0402_VAR	14V/46V
R308	1430740	Bottom	C	6	Resistor 5% 63mw	0402R	330R ~
R309	1430740	Bottom	C	7	Resistor 5% 63mw	0402R	330R ~
R350	1413850	Top	B	3	Chipres 0w125 4r7 J	0805R_THERM	4R7 ~
R357	1430792	Bottom	P	7	Resistor 5% 63mw	0402R	33k ~
R359	1430778	Bottom	P	8	Resistor 5% 63mw	0402R	10k ~
R360	1430804	Bottom	P	8	Resistor 5% 63mw	0402R	100k ~
R361	1620019	Bottom	P	6	Res Network 0w06 J	0404_R_SR	2x10k ~
R367	1430786	Bottom	N	8	Resistor 5% 63mw	0402R	18k ~

Table 3: TB4_1

Item	Code	Side	X	Y	Name	Type	Value	
R369	1430792	Bottom	N	6	Resistor 5% 63mw	0402R	33k	~
R386	1430690	Bottom	T	3	Chipres 0w06 Jumper	0402R	0R	~
R388	4120071	Top	Q	5	Asip Emif03-sim01 Sim	uBGA8	~	~
R420	1430726	Top	N	4	Resistor 5% 63mw	0402R	100R	~
R421	1430778	Top	N	5	Resistor 5% 63mw	0402R	10k	~
R422	1430873	Top	N	5	Chipres 0w06 F	0402R	27k	~
R423	1430778	Top	M	5	Resistor 5% 63mw	0402R	10k	~
R450	1430770	Top	R	5	Resistor 5% 63mw	0402R	4k7	~
R500	1430693	Bottom	M	3	Chipres 0w06 5r6 J	0402R	5R6	~
R501	1430754	Bottom	M	4	Resistor 5% 63mw	0402R	1k0	~
R502	1430337	Bottom	M	4	Chipres 0w06 9k1 F	0603R	9k1	~
R503	1430770	Bottom	J	6	Resistor 5% 63mw	0402R	4k7	~
R504	1430788	Bottom	J	6	Resistor 5% 63mw	0402R	22k	~
R516	1620033	Bottom	M	6	Res Network 0w06 J	0404_R	2x5k6	~
R517	1620033	Bottom	M	6	Res Network 0w06 J	0404_R	2x5k6	~
R520	1430774	Bottom	M	8	Resistor 5% 63mw	0402R	6k8	~
R522	1430784	Bottom	M	5	Resistor 5% 63mw	0402R	15k	~
R523	1430772	Bottom	L	4	Resistor 5% 63mw	0402R	5k6	~
R525	1430770	Bottom	L	4	Resistor 5% 63mw	0402R	4k7	~
R540	1430754	Bottom	J	3	Resistor 5% 63mw	0402R	1k0	~
R703	1430714	Bottom	E	8	Resistor 5% 63mw	0402R	33R	~
R704	1430714	Bottom	F	8	Resistor 5% 63mw	0402R	33R	~
R706	1430681	Bottom	C	8	Chipres 0w06 4r3 J	0402R	4R3	~
R709	1430754	Bottom	E	4	Resistor 5% 63mw	0402R	1k0	~
R710	1430766	Bottom	F	4	Resistor 5% 63mw	0402R	3k9	~
R713	1430691	Bottom	D	8	Chipres 0w06 2r2 J	0402R	2R2	~
R714	1430690	Bottom	E	5	Chipres 0w06 Jumper	0402R	0R	~
R750	1430690	Bottom	F	7	Chipres 0w06 Jumper	0402R	0R	~
R800	1430700	Bottom	F	4	Resistor 5% 63mw	0402R	10R	~
R801	1430726	Bottom	F	4	Resistor 5% 63mw	0402R	100R	~
R808	1620031	Bottom	E	3	Res Network 0w06	0404_R_SR	2x1k0	~
S300	5209001	Bottom	E	2	Sm Sw Tact Spst 12v 50ma	EVQPUA02	~	~

Table 3: TB4_1

Item	Code	Side	X	Y	Name	Type	Value	
S301	5209001	Bottom	G	2	Sm Sw Tact Spst 12v 50ma	EVQPUA02	~	~
S302	5409235	Bottom	B	7	Sm Tact Sw Trav	SKRE_II	~	~
T500	3640423	Bottom	K	3	Balun Trans 3.7ghz	TRANS_LDB15	~	~
T700	4550223	Bottom	F	8	Transf Balun 1800+-100mhz	TRANS_LDB15	~	~
V100	4113721	Top	S	5	Tvs Di 1pmt16at3 16v 175w	CASE_457	~	~
V300	4110475	Bottom	I	9	Sch Di Rb521s-30	EMD2	~	~
V356	4110965	Bottom	P	8	Cap.di Bb202 Ct=2.5 Fm	SOD_523	~	~
V357	4110965	Bottom	P	8	Cap.di Bb202 Ct=2.5 Fm	SOD_523	~	~
V801	4219903	Bottom	D	3	Trx2 Bfm505 N	SOT_363	~	~
V802	4210261	Bottom	F	3	Tr Bga428 Lna1.8ghz 19.5db	SOT_363	~	~
X100	5409141	Bottom	H	5	Sm Battery Conn 4pol Spr.	297449C	~	~
X101	5460061	Bottom	U	6	Sm System Connector 14pol	MQ202_	NK_14R3	
X301	5469135	Top	M	8	Sm Conn 2x8 aPcb/pcb	CPBT297884_6	~	~
X302	5469175	Top	C	7	Sm Conn Btb 2x5 F P0.5	DF23C_10DS	~	~
X386	5400085	Bottom	P	4	Sim Card Reader 2x3	HD940	~	~
Z300	4120031	Top	M	4	Emi/esd Filt Emif	uBGA24	~	~
Z700	4511337	Bottom	D	8	SAW Filt	DCC6D	897.5MHz	
Z800	4550237	Bottom	D	8	Ant.sw+2SAW	DGM002M06	880-960/1710-1990MHz	
Z802	3640427	Bottom	F	4	Balun Trans 1.9ghz	TRANS_LDB20	~	~
Z806	4511339	Bottom	E	3	Saw Filt 5	DCS4D_H1.0	1960MHz	

Parts list TK4 UI module 0201827 for NHL-4

EDMS v. 3.0

Item	Code		
V101	4864573	led cl191wbva ** reserve	RESERVE
V102	4864573	led cl191wbva ** reserve	RESERVE
V103	4864573	led cl191wbva ** reserve	RESERVE
V104	4864573	led cl191wbva ** reserve	RESERVE
V105	4864573	led cl191wbva ** reserve	RESERVE
V106	4864573	led cl191wbva ** reserve	RESERVE
	9795197	Key dome sheet	Not a spare part
	9854600	PWB TK4 50.7X39.9X0.6 M4	Not a spare part

Parts list TK7 UI module 0201909 for NHL-4U

EDMS v. 2.1

Item	Code		
V101	4864573	led cl191wbva ** reserve	RESERVE
V102	4864573	led cl191wbva ** reserve	RESERVE
V103	4864573	led cl191wbva ** reserve	RESERVE
V104	4864573	led cl191wbva ** reserve	RESERVE
V105	4864573	led cl191wbva ** reserve	RESERVE
V106	4864573	led cl191wbva ** reserve	RESERVE
	9795109	Key dome sheet	Not a spare part
	9854655	PWB TK7	Not a spare part

[This page left intentionally blank]